

GLUE 1/16" SQ. OVER PLAN

ELEVATOR ASSEMBLED OVER PLAN

POSITION OF ELEVATOR

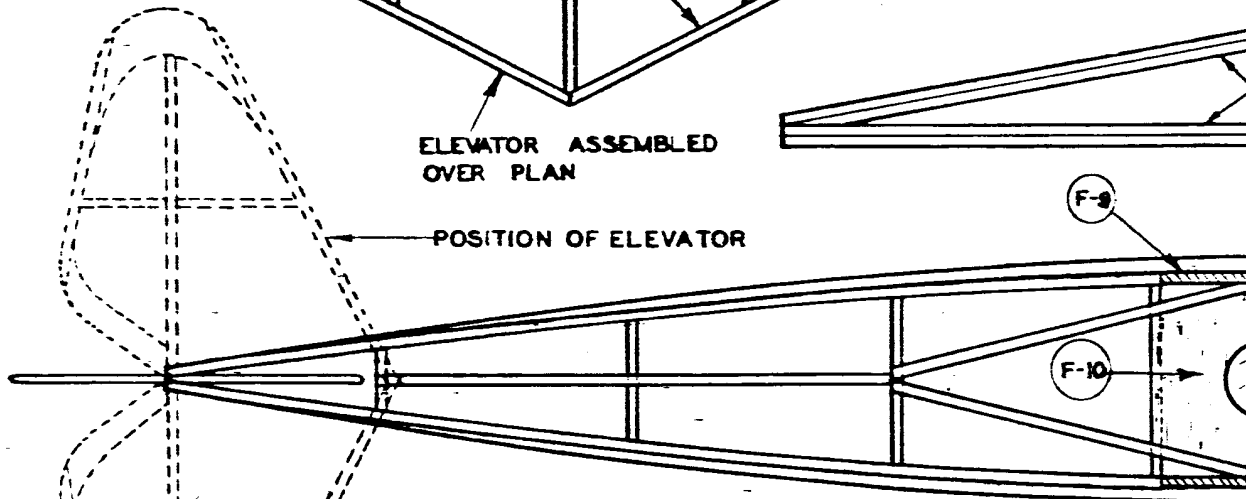

TOP VIEW

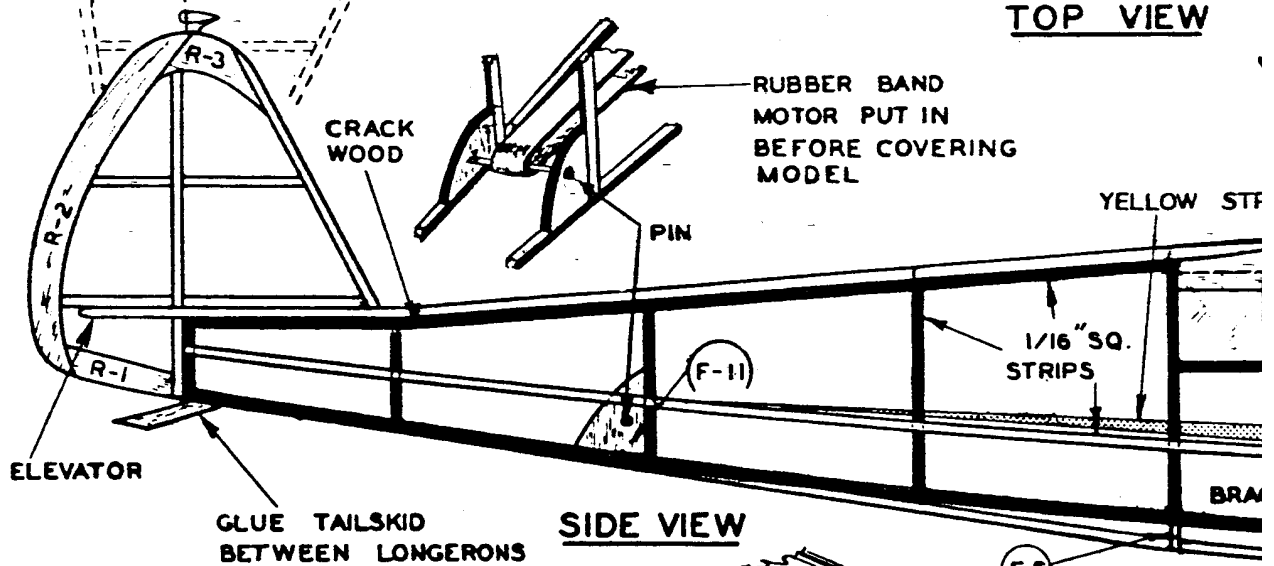

SIDE VIEW

(F-5)

GLUE STRUT HERE

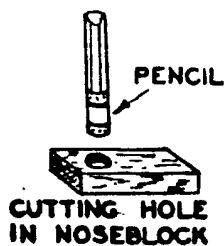

WING STRUT ATTACHMENT



GLUE LANDING GEAR FIRMLY TO LONGERON

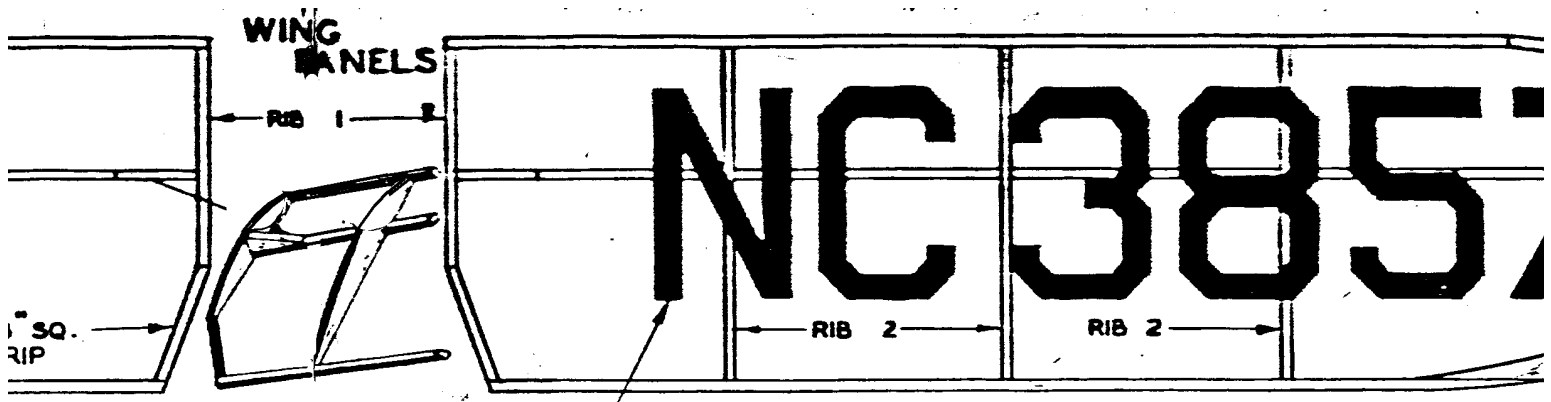

CUT OUT LICENSE NUMBERS

FRONT VIEW 1/2 SIZE

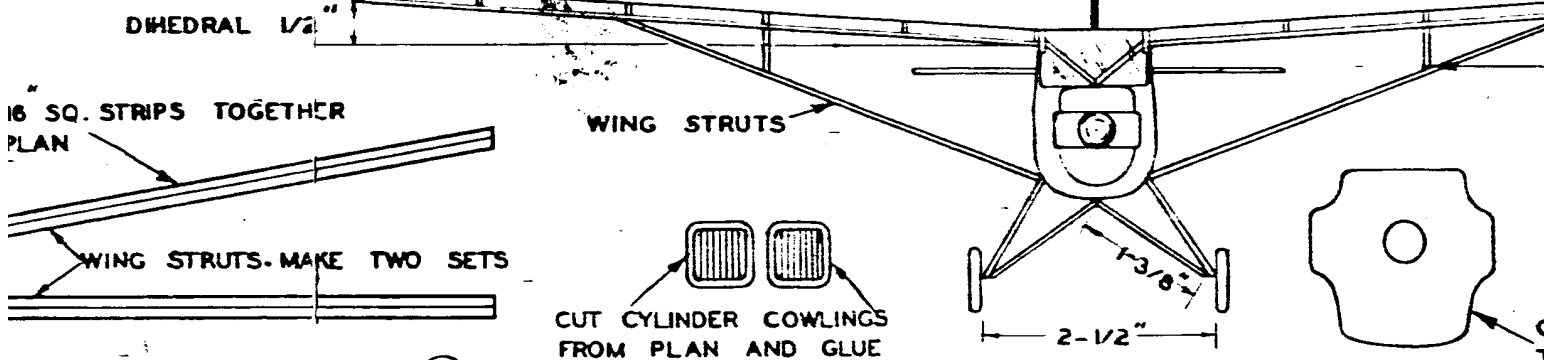

CUT CYLINDER COWLINGS FROM PLAN AND GLUE TO NOSE BLOCK

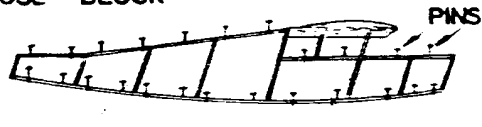
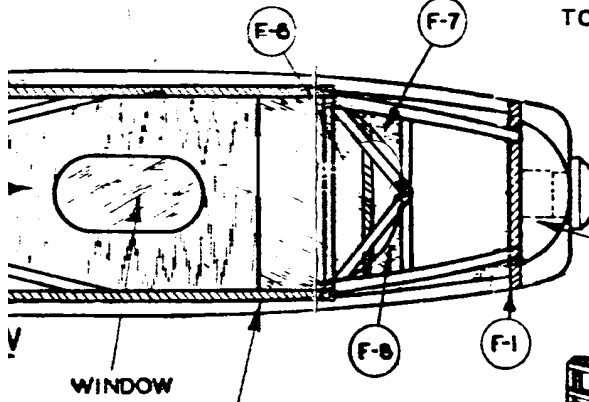

COLOR SCHEME -
 BODY- DARK BLUE
 WING, RUDDER &
 ELEVATOR -YELLOW

FOR SHO

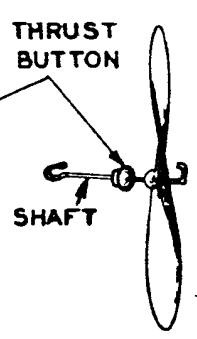
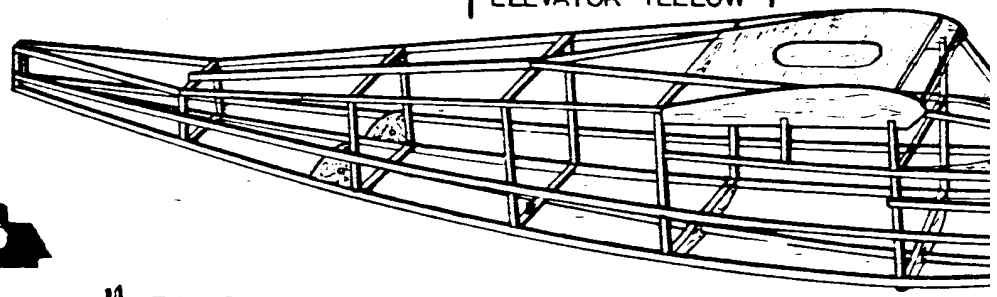
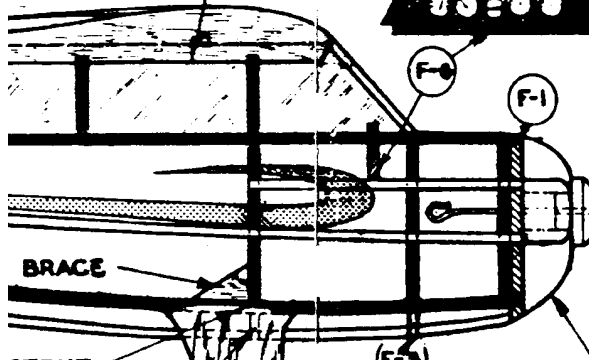
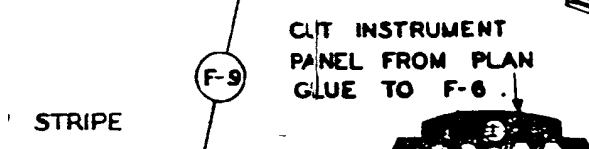

IF RUBBER MOTOR CANNOT BE OBTAINED FROM YOUR MODEL SUPPLY DEALER, USE RUBBER LOOP CUT FROM OLD INNER TUBE OR SEVERAL SMALLER BANDS JOINED.

IN FL TEND SMALL NOSE

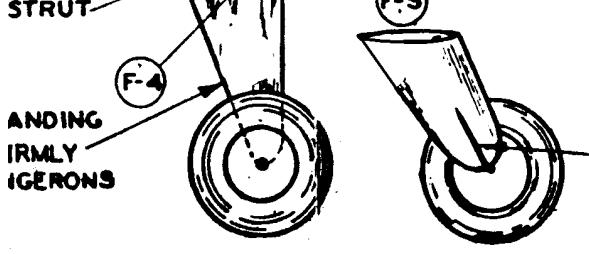

LUSCOMBE

WINGSPAN 16"

DRAWN BY *Sidney*

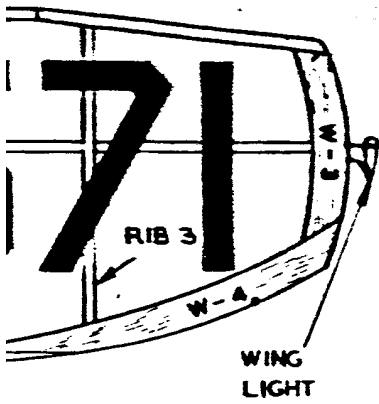

SIZE

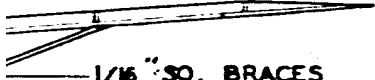

1/16" SQ. BRACES

FINISHED
NOSE BLOCK



CUT NOSE BLOCK
THIS SHAPE

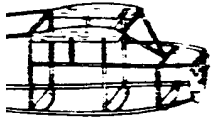

STEP

FORMER 6 NOT
SHOWN

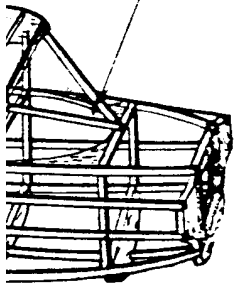

IN FLYING, IF MODEL
TENDS TO STALL, ADD
SMALL WEIGHTS TO THE
NOSE.

MBE "50"

" LENGTH 10 "

Arny Afalrod | KIT NO.A2